



X-Digital WallPaper Series
Indoor COB Regular 640 x 480mm
1.25mm|1.53mm|1.86mm

X-Digital LED Panel Flip-Chip COB

X-DIGITAL LED PANEL FLIP-CHIP COB:

- Key Feature:
- Multi-size combination LED Panel
- High Precision Die-Casting Aluminum Frame
- Completely access to front service
- Shockproof, Static Free & Anti-oil Stain

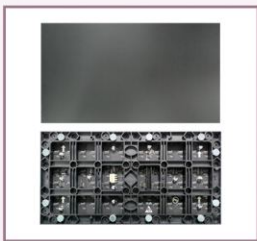

Flip-chip COB

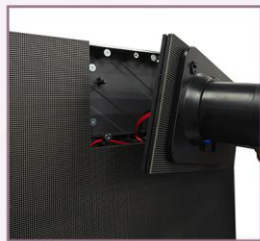

Front Service totally



Position Pin

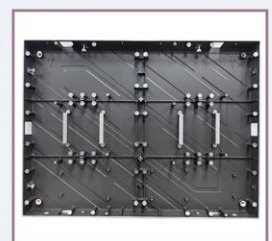

Die-casting Aluminum Frame

High Grayscale & Low Brightness

X640 Indoor Series supports calibration technology, the products brightness and color will Performance uniform and consistent after calibration.

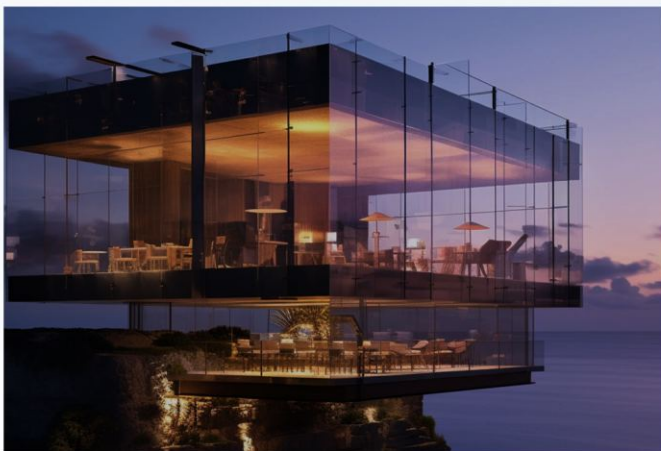

Before Processing



After Processing

Widely Viewing Angle

XD640 COB Indoor Screens can provide a wide viewing angle up to 160° horizontal, and leads more audience who sit in different place to admire stunning audio-visual feasts.

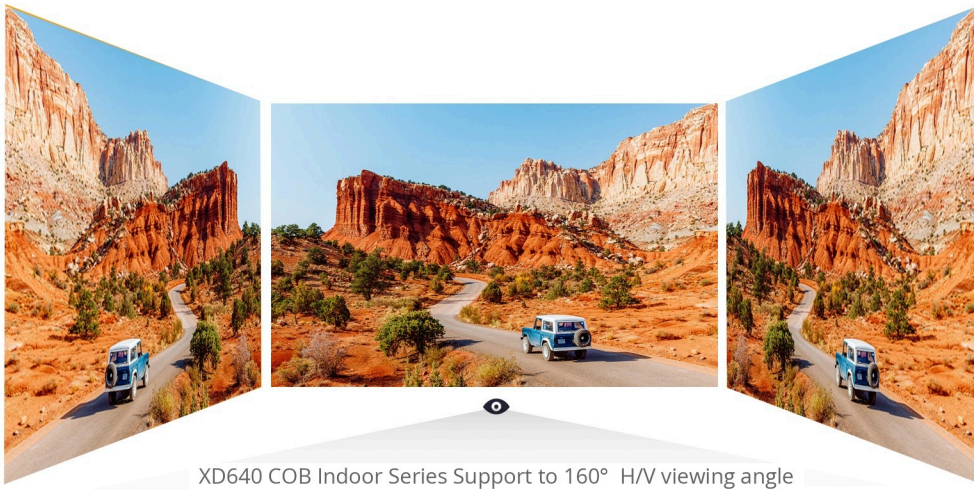

XD640 COB Indoor Series Support to 160° H/V viewing angle

2K 4K 8K Panel Displays

XD640 COB Indoor panels can be quickly spliced into a 16:9 screen according to your project needs, achieve to 2K, 4K or even 8K visual display.

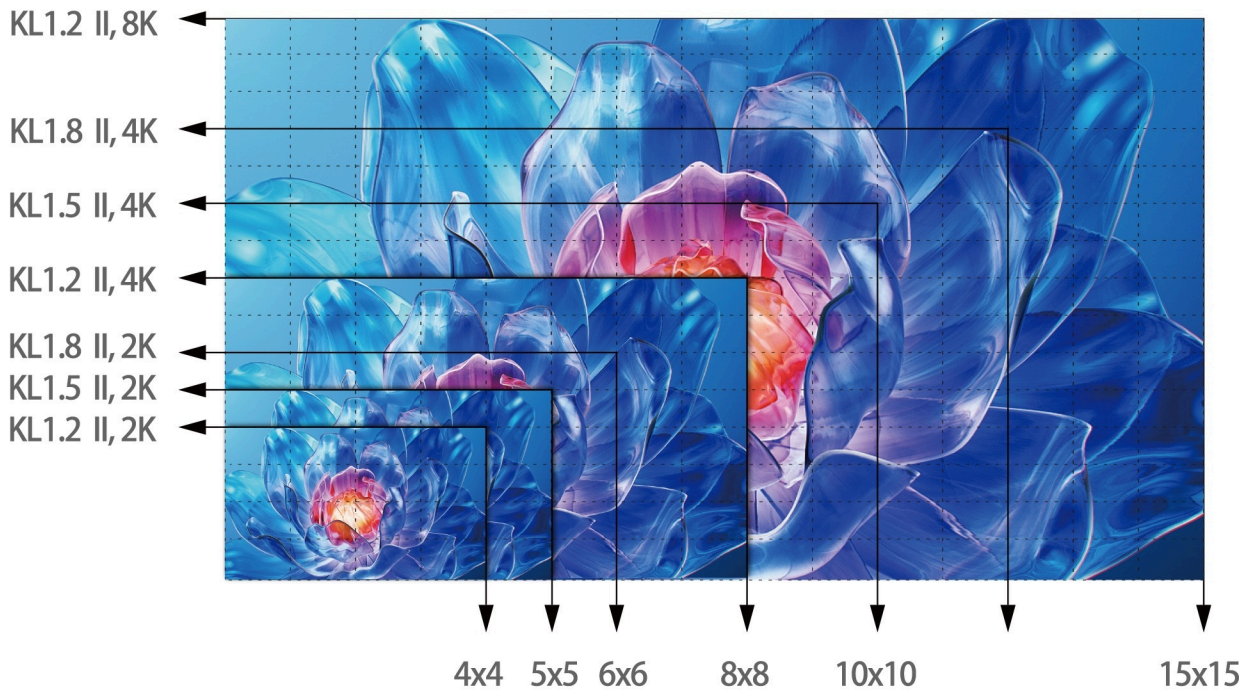

XD640 COB Indoor Series

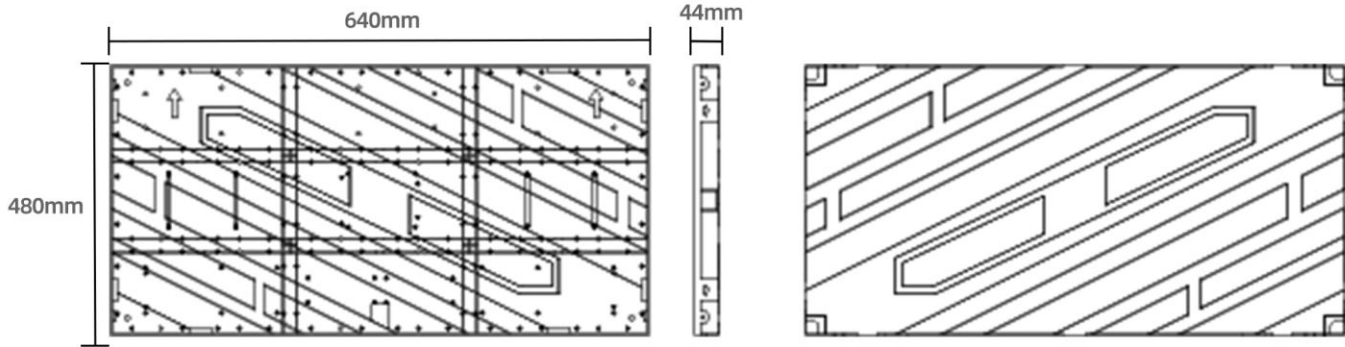

X-Digital WallPaper Series		XD125	XD153	XD186
Physical Parameters	Pixel Pitch	1.25mm	1.53mm	1.86mm
	LED Type	Fully Flip Chip-COB (Mat)		
	Module Size (mm)	320 x 160	320 x 160	320 x 160
	Module Resolution (dots)	256 * 128	208 * 104	172 * 86
	Pixel Density (dot/S.qm)	640,000	422,753	288,906
	Unit Module G.W (kg)	0.50	0.50	0.50
	Regular Panel Size ① (W x H x D)	640 x 480 x 63mm		
	Regular Panel ① Resolution (dots)	512*384	418*314	344*258
	Regular Panel ② Size (W x H x D)	640 x 640 x 63mm		
	Regular Panel ② Resolution (dots)	512*512	418*418	344*344
	Panel Size ③ (W x H x D)	960 x 480 x 63mm		
	Regular Panel Resolution ③	768*384	627*314	516*258
	Panel Size ④ (W x H x D)	320 x 640 x 63mm		
	Regular Panel Resolution ④	256*512	208*418	172*344
	Panel Size ⑤ (W x H x D)	320 x 480 x 63mm		
	Regular Panel Resolution ⑤	256*384	208*314	172*258
Frame Material	Die-casting Aluminum			
Electronic Parameters	Brightness (cd/m ²)	600nits Calibrated		
	Single Pixel Brightness Correction	Supported		
	Single Pixel Color Correction	Support		
	Refresh Rate (Hz)	3840Hz		
	Grayscale (bit)	13bit		
	Contrast Ratio	≥10000:1		
	Color Temperature (K)	9300K		
	View Angle (H/V °)	170°/170°		
	Drive Mode	Constant Current Drive		
	Frame Frequency (Hz)	50/60 Hz		
	AC Operating Voltage	100-240V		
	Max. Power Consumption (W/m ²)	≤375		
Ave. Power Consumption (W/m ²)	≤125			
Application Parameters	Storage Temperature (°C)	-40 ~ + 60		
	Operating Temperature (°C)	-10° ~ + 40		
	Storage Humidity (RH)	10% ~ 85%		
	Operating Humidity (RH)	10% ~ 80%		
	IP Rating (Front & Rear)	IP3		
	LED Typical Lifetime (hrs)	≥100,000		
	Maintenance Method	Front Service		
	Installation Type	Indoor Fixed Installation		



✉ info@xiv-tec.com

📍 Building 4A-303, Huiye Hi-Tech Industry Park,
Fenghuang Str. Guangming District, Shenzhen, China

CE  RoHS  us